

VALIANT (1BCAL)

The Valiant One Bolt Aluminium single cable cleat is a metallic cleat which has been designed, constructed, and tested in accordance with the International Standard 'cable cleats for Electrical Installations' (IEC 61914).

It ensures the retention and securing of single cables, without damaging or deforming the cable. The cable cleat is manufactured from high pressure die cast aluminium (LM20) making it suitable for both indoor and outdoor applications. Due to its unique twin arc internal patent pending design profile it exhibits excellent retention, limiting both the axial and lateral movement. The Valiant One Bolt cable cleat is available in twelve sizes suitable for cable diameters of 10mm up to 71mm. The cable cleat has an M10 clearance hole for securing it to a mounting surface.

FEATURES

- Third party certification to IEC 61914
- Available in high pressure die cast aluminium
- Sunlight (UV) resistant
- Operating temperature -60°C to +150°C
- Can be double stacked
- 10 - 71mm in 12 sizes
- Excellent axial & lateral load retention
- Single bolt fixing design

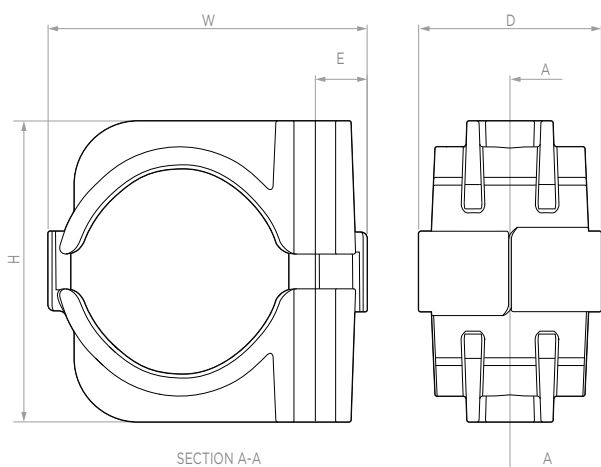

TECHNICAL DATA & CLASSIFICATION

| | |
|---------------------------------------|---|
| TYPE | 6.1.1 Metallic 1BCAL - One Bolt Aluminium Cable Cleat |
| DESIGN SPECIFICATION | IEC 61914 |
| TEMPERATURE FOR PERMANENT APPLICATION | -60°C to +150°C IEC 61914 clause / part 6.2 |
| NEEDLE FLAME TEST | Pass IEC 61914 clause 10.0, 10.1, IEC 60695-11-5 |
| LATERAL LOAD TEST | 5kN - 6kN IEC 61914 clause 9.3 |
| AXIAL LOAD TEST | 1.5kN IEC 61914 clause 9.4 |
| IMPACT RESISTANCE | Pass - Very Heavy IEC 61914 clause 6.3, 6.3.5, 9.2 |
| MATERIAL | High pressure die cast aluminium |
| MATERIAL COLOUR | Silver / grey |
| UL CERTIFICATE | E490770 |
| UL STANDARD(S) FOR SAFETY | UL 2239, Support of Conduit, Tubing, and Cable. CSA-C22.2 No. 18.4-15, Hardware for the support of Conduit, Tubing, and Cable. |

SHORT CIRCUIT TESTING TO IEC 61914 - CLAUSE 9.5

| MULTICORE FORMATION | | PARALLEL FORMATION | |
|---|--|--|---|
| One short circuit 600mm fixed cleat centres | Two short circuits 600mm fixed cleat centres | One short circuit 600mm fixed cleat centres 105mm cable centres | Two short circuits 600mm fixed cleat centres 105mm cable centres |
| 0.1 sec | 0.1 sec | 0.1 sec | 0.1 sec |
| 118kA Peak | 89kA Peak | 90kA Peak | 76kA Peak |
| 53.6kA r.m.s | 42.3kA r.m.s | 42.8kA r.m.s | 36.1kA r.m.s |



CABLE CLEAT SELECTION TABLE

| VALIANT PART NO. | CABLE Ø RANGE TAKE (MM) | DIMENSIONS MM | | | | | FIXING HOLE Ø | WEIGHT (g) *(LUL +5%) |
|------------------|-------------------------|---------------|----|----|----|---------|---------------|-----------------------|
| | | W | H | D | E | | | |
| 1BC1013A | 10 - 13 | 41 | 34 | 46 | 13 | 1 x M10 | 57 | |
| 1BC1316A | 13 - 16 | 44 | 37 | 46 | 13 | 1 x M10 | 66 | |
| 1BC1619A | 16 - 19 | 47 | 40 | 46 | 13 | 1 x M10 | 74 | |
| 1BC1923A | 19 - 23 | 51 | 44 | 46 | 13 | 1 x M10 | 83 | |
| 1BC2327A | 23 - 27 | 55 | 48 | 46 | 13 | 1 x M10 | 93 | |
| 1BC2732A | 27 - 32 | 61 | 56 | 46 | 13 | 1 x M10 | 114 | |
| 1BC3238A | 32 - 38 | 67 | 62 | 46 | 13 | 1 x M10 | 130 | |
| 1BC3845A | 38 - 45 | 75 | 73 | 46 | 13 | 1 x M10 | 162 | |
| 1BC4551A | 45 - 51 | 81 | 76 | 46 | 13 | 1 x M10 | 181 | |
| 1BC5158A | 51 - 58 | 86 | 83 | 46 | 13 | 1 x M10 | 199 | |
| 1BC5865A | 58 - 65 | 94 | 90 | 46 | 13 | 1 x M10 | 222 | |
| 1BC6571A | 65 - 71 | 101 | 97 | 46 | 13 | 1 x M10 | 240 | |

Coatings are available upon request by adding the following suffixes to the ordering reference - EC for epoxy coating, PC for polyester coating and TC for thermoplastic coating. Example order reference for epoxy coating suffix EC (1BC1013AEC). Fasteners required to secure the cable cleat to the support structure are not included but can be supplied upon request - see cleat fixing pack page 64-65. Isolation/separation pads (to prevent corrosion between two dissimilar metals) are not included but can be supplied on request - see isolation/separation pad page 66.